

6-FM-4.5

12V 4.5Ah LEAD-ACID STORAGE BATTERY

PRODUCT FEATURES:



- **12V Nominal Voltage** - The battery supplies a steady 12VDC output, which is a standard voltage used in UPS systems, alarms, and backup power equipment.
- **4.5Ah Capacity** - This indicates how much charge the battery can store. A 4.5Ah battery can deliver 0.225Amps for 20 hours, or higher current for a shorter time.
- **Sealed Lead-Acid (SLA / VRLA) Design** - The battery is completely sealed, preventing electrolyte leakage. It uses valve-regulated technology for safe operation.
- **Non-Spillable and Leak-Proof** - The electrolyte is absorbed inside the battery (AGM type), allowing safe indoor use and flexible mounting positions.
- **Low Self-Discharge** - The battery loses very little charge when not in use, ensuring it remains ready during long standby periods.
- **Long Standby Life** - Designed for float charging.
- **Low Internal Resistance** - Enables efficient power delivery and supports high current demand when required.
- **Compact and Rugged Construction** - The ABS plastic casing protects the battery from vibration and physical damage.

TECHNICAL SPECIFICATIONS

Model	6-FM-4.5			
Nominal Voltage	12V			
Capacity	4.5Ah (0.225A, 20hr, 10.5V)			
Dimensions	100L x 90W x 70H (mm)			
Internal Resistance	Full charged at 25°C: 30.00 mΩ			
Self Discharge	2% of capacity declined per month at (25°C)			
Capacity Affected by Temp.(20HR)	40°C	25°C	0°C	-15°C
	102%	100%	85%	65%
Charge Voltage(250°C)	Cycle use		Float use	
	14.4-15.0V(-30mV/°C)Max.Current: 2.10Amps		13.5-13.8V(-20mV/°C)	
Weight	1.2KG			

DIMENSION:

Outer Dimension(mm)

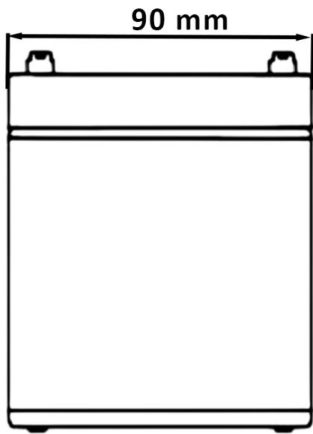

Side View

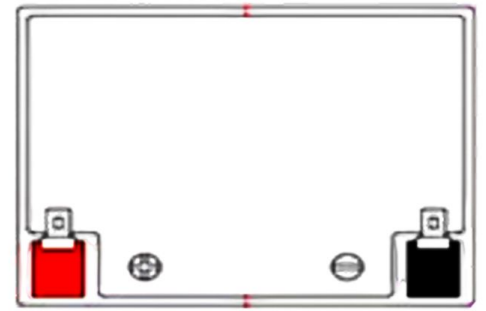
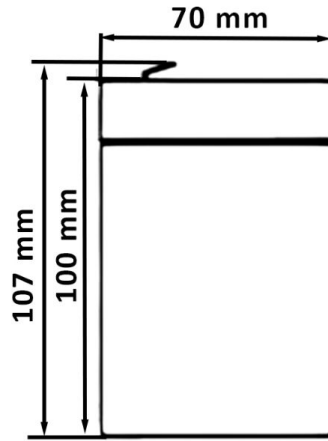

Top View

Connection Terminal (Top View)

- Terminal T1

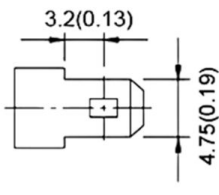

- Terminal T2

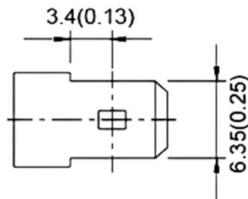

Connection Terminal (Side View)

- Terminal T1

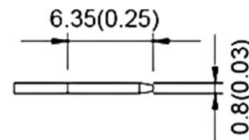

- Terminal T2

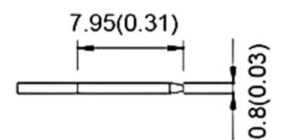

Connection diagram in parallel (Increasing the Ampere)

- Positive to Positive:** Connect the positive terminal (+) of the first battery to the positive terminal of the second battery using a red jumper wire.
- Negative to Negative:** Connect the negative terminal (-) of the first battery to the negative terminal of the second battery using a black jumper wire.
- Connecting the Load:** For a balanced draw that ensures both batteries age equally, connect your device's positive wire to the first battery and its negative wire to the last battery in the chain.

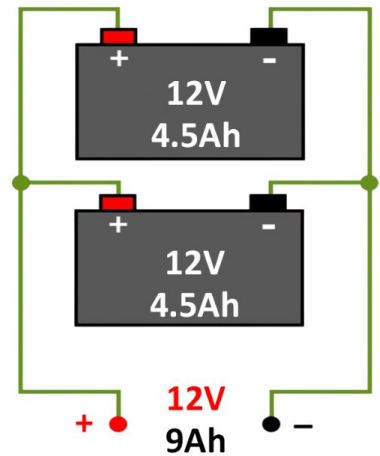

Connection diagram in Series (Increasing the Voltage)

- Positive to Negative:** Use a jumper wire to connect the negative terminal (-) of the first battery to the positive terminal (+) of the second battery.
- Continue the Chain:** For more voltage, repeat this by connecting the negative of the second battery to the positive of the third, and so on.
- Connecting the Load:** Your device or application connects to the remaining open positive terminal on the first battery and the open negative terminal on the last battery.

