

F-C02WDT

DOOR CONTACT



Product Features

- High quality door contact with high grade magnet and designed in miniature size which ease for installation.
- Suitable for most security system.
- Reed Form: SPDT

Technical Specification

Model	F-C02WDT
Voltage	100VDC
Current	0.5A
Power	10W
Output	NO/NC/COM
Standard Color	White
Work Gap	10~20mm
Installation	Concealed drilling
Material	ABS
Dimension	φ10 * 17mm

Dimension

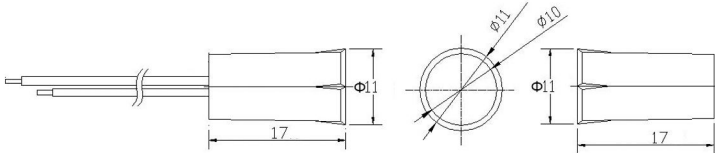

Installation

